

Easy Pow'air MT240

US

Easy Pow'air MT240 : GENERAL FEATURES

Manufacturer's reference I60.10.060 & I60.10.061
 Manufacturer LEADER S.A.S, Octeville sur mer - FRANCE

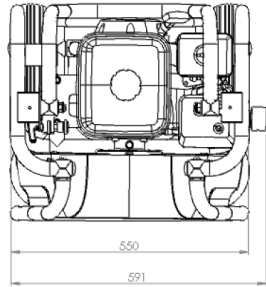
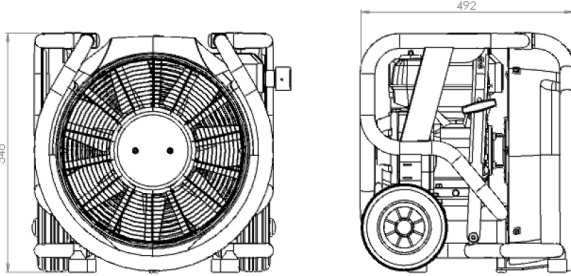

Weight : 43 Kg
 +/- 0.5 Kg

H : 548 L : 550 PR : 492
 +/- 5mm

Construction :

- Chassis in ø 30mm steel tube – epoxy coating
- Engine Honda GX160 type – 4-stroke – 6.5 HP at 3600 rpm (SAEJ1349 : 5.5CV)
- Guard of the turbine in double polyethylene skin
- Turbine made of composite resin - ø 420 mm – aluminium axle
- Operating autonomy _ 2h 00 at full speed
- Standard equipment : engine stops automatically in the event of shortage of oil or if the fan is accidentally knocked over.
- Noise level around 92.1 dB(A) at 3 m.
- Retractable handle, two 200mm diameter wheels.
- Angle of tilt adjustable (from 10° to 20°).
- Airflow: 49681 m³/h

Guarantee:

2 years, parts and labour, for the engine, see manufacturer's documentation

This equipment is designed and manufactured in FRANCE, in compliance with CE directives.

This equipment should be used only by firefighting professionals

INSTRUCTIONS FOR START-UP :

The following checks must be carried out before first starting the fan:

- Make a visual check of the **MT240** and its accessories to make sure that no damage occurred during transport.

ATTENTION: Do not attempt to start the **MT240** ventilator if you notice any kind of anomaly. Contact **Leader SA** immediately.

- Check that the manual for the HONDA is contained in the pack.

With the engine off, pull the recoil starter. If there is any unusual noise, or if the turbine gets stuck, stop the engine and contact **Leader SA** immediately.

Read the instruction manual for the engine before filling up with oil or petrol.

Use the fuel and lubricant recommended in the instruction manual for the engine: fresh, unleaded petrol with an octane rating of at least 85.

Fill the engine's oil sump with a type of oil recommended in the instruction manual.

MT240 : engine HONDA: oil capacity: 0.5 litre (20W50)

The limits for oil use are shown in the HONDA engine manual.

Make sure that everyone responsible for or using this equipment is fully aware of the safety and operating precautions pertaining to rotating machinery.

NB : By its nature, a petrol engine creates vibrations. It is normal for the fan to vibrate when in use, particularly at medium power. To ensure better stability for the **MT240** fan, particularly on an uneven surface, put the accelerator up to maximum power. This will reduce the vibrations and improve the equipment's stability.

It is possible that there will be some extraneous vibration during the engine's running-in period. These will disappear after several hours' use.

START-UP OPERATIONS :

The way the **MT240** fan is started depends on the terrain on which it is being used.

- 1/ Check that the fuel tank is full.
- 2/ Check that there is no fuel leakage.
- 3/ Place the **MT240** fan on a flat surface where there are no slippery products and which is clear of debris. Make sure there is no obstacle between the fan and the opening for air entry.
- 4/ Start the fan after making sure that it is in a stable position, and adjust the accelerator so as to obtain the desired airflow. (For more information, see the engine manufacturer's manual).
- 5/ During blowing operations, regularly check that no obstacle is preventing the airflow from penetrating the interior of the building, or blocking the fan's suction grill

ADJUSTING THE TILT:

Use between 2 and 6 metres from the opening

1) Lift the carrying handle, the fan is automatically tilted to an angle of 10° (operating angle recommended for 90% of incidents).



2) To close the carrying handle, unlock it using the index pin (ref. A).

ADJUSTING THE TILT: LANDING, ENTRY WITH STEPS, WINDOW:

Use between 4 and 6 metres from the opening

1) To adjust the tilt between 10° and 20°, unlock the tilt adjustment lever by moving it a quarter turn.

3). Lock the lever while holding the fan in place so as not to alter the tilt.

2) Tilt the fan manually so as to centre the jet on the opening.

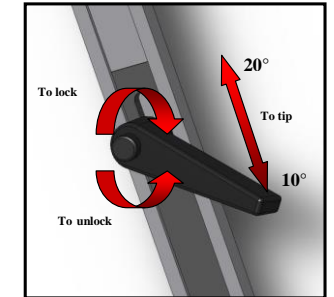
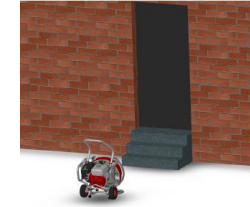

Must be deployed
 Before start the engine

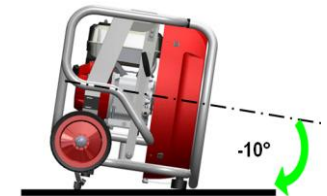
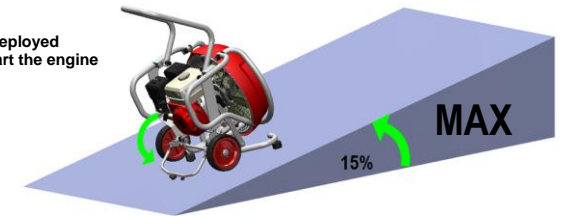

IMPORTANT: READ BEFORE USE

MT240.0ZN.3.34.US.1



FABRICANT
MANUFACTURER

FABRICANTE

LEADER S.A.S.

Z.I. des Hautes-Vallées
Chemin n° 34
CS20014
76930 Octeville sur Mer
France



www.leader-group.eu

www.LeaderNorthAmerica.com

Our policy is to constantly seek to improve our products. We therefore reserve the right to change their technical specifications at any time and without prior notice. - Non contractual images



SAFETY INSTRUCTIONS :

This equipment is manufactured in compliance with CE directives. It should be used only by fire-fighting professionals.

Read this manual completely, together with the attached instructions for the use and maintenance of the engine before starting up or using the equipment.

Do not remove the petrol tank stopper, or fill the tank, while the engine is running or when it is hot (let the engine cool down for 2 minutes before filling the petrol tank).

Keep fingers and hands away from the turbine and the hot parts of the equipment (cylinder block and exhaust).

Do not start up the engine when the air filter or the air filter cover are removed.

Always use recently produced unleaded petrol. Petrol which has been stored for a long time forms a deposit which could block the carburettor.

Do not run the engine in an enclosed space. (The exhaust gases contain carbon monoxide.)

Do not fill the petrol tank in an unventilated area.

This ventilator must be operated or repaired only by qualified, trained staff.

Do not start up the engine if the blades or the protective shroud show any signs of damage.

Never move the ventilator when it is running at full speed.

Only use genuine spare parts supplied by LEADER S.A. when replacing defective parts.

During maintenance operations, the wire leading to the spark-plug should be removed and fixed elsewhere.

MT240 type blowers must not be used in explosive atmospheres.

Do not remain in the fan's outlet area (risk of flying debris).

Keep this equipment out of reach of children.

Wear safety glasses, gloves and earmuffs when using this ventilator.

Never allow anyone to use a ventilator without first giving them the necessary instructions.

Do not wear loose clothing which could get caught in the ventilator.

Do not use chocks or any other system for increasing the ventilator's tilt angle.

Do not forget to put oil in the ventilator's engine before use.

This document has been drawn up in order to help you get to know how to use your **MT240** ventilator.

All operating and safety instructions must be strictly followed in order to avoid accidents or problems. All operations involving dismantling or repair must be carried out by LEADER S.A., or by an approved dealer.

This document demonstrates the ease of use and maintenance of the **MT240** ventilator. If you have any suggestions for improving this document, **LEADER S.A.** would be very happy to hear them. Please do not hesitate to contact us.

PRECAUTIONS FOR USE :

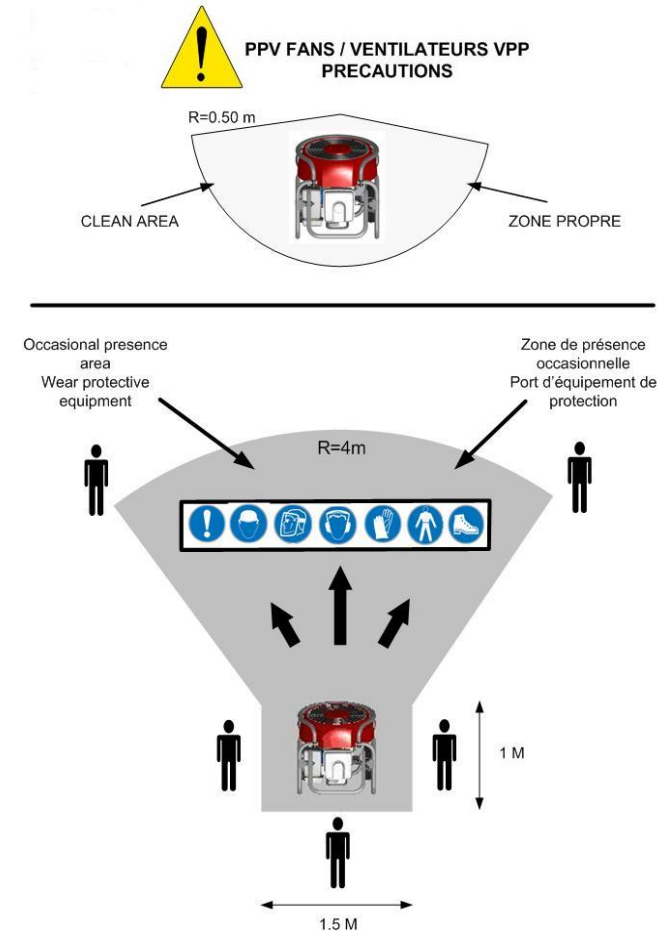

NB : MT240 ventilators operate on the high-speed entrained air principle. These portable ventilators are designed to clear smoke and gas, volatile or otherwise, by their blowing (or positive power) action, in all types of premises where an exit has been prepared. They are designed to be used between 2 and 6 metres away from the opening concerned. **Leader SA** recommends that the minimum opening for escaping smoke should be the same size as the entry opening : the ideal would be double the size.